

4H Series

Hand Pull Valve



The way to automation

- Valve
- 4V100
- 4V200
- 4V300
- 4V400
- Manifold
- 3V1
- JEL
- JZF
- MVSD
- VF, VZ
- BM, PU, AM
- Diaphragm
- Coil
- 2V
- 2W
- 2W(Big)
- 2P
- 2L
- VX
- PU
- PU225
- 2Q
- JEL5404
- JEL6213
- Pulse
- JELJZF
- 4H**
- TSV
- MPV
- 4HV
- HV, K
- 4R
- 4F
- MSV
- JM
- ASC, RE
- QE, QEA
- ST
- HSV



Ordering Code

4H	2	10	C	06	L
↓	↓	↓	↓	↓	↓
Specification	Series Code	Position Number	Middle Position	Port Size	Type
4H: 5/2(3) Way	2: 200 Series 3: 300 Series 4: 400 Series	10: Single head two position 30: Single head three position	C: Mid-position closed E: Mid-position exhaust P: Mid-position pressure	06: G 1/8" 08: G 1/4" 10: G 3/8" 15: G 1/2"	Blank: 5/2 way lock type L: 5/3 way lock type S: 5/2 (3) way spring return type

Specification

Model	4H210-06	4H210-08	4H230-08	4H310-08	4H310-10	4H330-10	4H410-15	4H430-15
Working Medium	40 Micron Filtered Air							
Operation	Direct							
Effective Cross Section Area	14 mm ² (CV=0.78)	16 mm ² (CV=0.89)	12 mm ² (CV=0.67)	25 mm ² (CV=1.4)	30 mm ² (CV=1.68)	18 mm ² (CV=1.00)	50 mm ² (CV=2.79)	30 mm ² (CV=1.68)
Port Size	Inlet, Outlet, Exhaust Port = G 1/8"	Inlet, Outlet = G 1/4" Exhaust Port=G 1/8"	Inlet, Outlet, Exhaust Port = G 1/4"	Inlet, Outlet, Exhaust Port = G 1/4"	Inlet, Outlet = G 3/8" Exhaust Port = G 1/4"		Inlet, Outlet, Exhaust Port = G 1/2"	
Working Pressure	0 ~ 0.8 MPa							
Working Temperature	0 ~ 60 °C							

Overall Dimension

4H Series

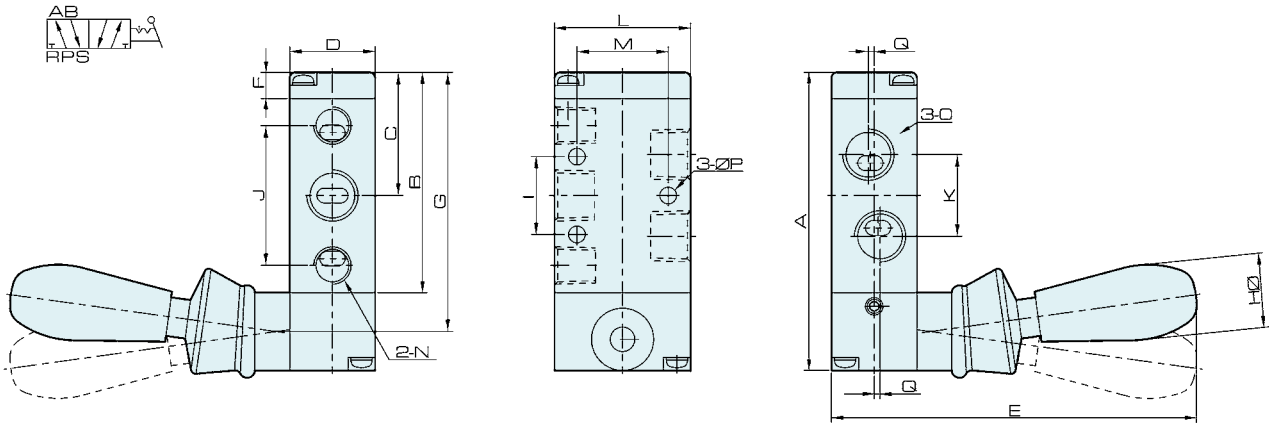

Dimension

Symbol	4H210-08(06)	4H230-08(06)-S (Automatic Rebound)	4H310-10(08)	4H330-10(08)-S (Automatic Rebound)	4H410-15	4H430-15-S (Automatic Rebound)
	4H230-08(06)-L		4H330-10(08)-L		4H430-15-L	
A	76	95	96	115	126	147
B	56.5	75.5	72	91	102	123
C	31.5	31.5	40	60	55.5	76.5
D	22	22	27	27	34	34
E	95	95	100	100	110	110
F	6.5	6.5	7.5	7.5	7.5	7.5
G	66.5	85.5	84	103	114	135
H	18	18	18	18	18	18
I	20	20	24	24	28	28
J	36	36	45	45	63	63
K	21	21	24	24	36	36
L	35	35	40	40	50	50
M	21	21	27	27	35	35
N	G 1/8	G 1/8	G 3/8	G 3/8	G 1/2	G 1/2
O	G 1/4 (G 1/8)	G 1/4 (G 1/8)	G 3/8 (G 1/4)	G 3/8 (G 1/4)	G 1/2	G 1/2
P	4.3	4.3	4.3	4.3	5.5	5.5
Q	1.5 (-)	1.5 (-)	2 (-)	2 (-)	-	-

Valve

4V100
4V200
4V300
4V400

Manifold

3V1

JEL

JZF

MVSD

VF, VZ

BM, PU, AM

Diaphragm

Coil

2V

2W

2W(Big)

2P

2L

VX

PU

PU225

2Q

JEL5404

JEL6213

Pulse

JEL, JZF

4H

TSV86

MPV

4HV

HV, K

4R

4F

MSV

JM

ASC, RE

QE, QEA

ST

HSV