

# CHECK VALVES

*Used in pneumatic piping &*

*Used for a wide variety of models to meet all needs.*



## PRODUCT DESCRIPTION

### FEATURES

- Air is completely blocked when the tube is released, the air flows again only after connection is safety secured.  
The air flows only when the tube is connected.

### SPECIFICATION

- Applicable Fluid Type / AIR (No other type of gas or liquid)
- Working Pressure Range / 0~150PSI / 0~9.9Kgf/cm<sup>2</sup>(0~990KPa)
- Negative Pressure / -29.5in Hg / -750mmHg(-750Torr)
- Working Temperature Range / 32~140°F / 0~60°C

## ORDER

### PLACING AN ORDER OR REQUEST

Specifying Standard Items

Please specify the following:

1. Series(Item)Number
2. Tube Outside Dia.
3. Thread Size

### THREAD SIZE

- 01:1/8"PT
- 02:1/4"PT
- 03:3/8"PT
- 04:1/2"PT

### Example of a request

CVPC series check valves,  
8mm tube with 1/4" BSPT thread

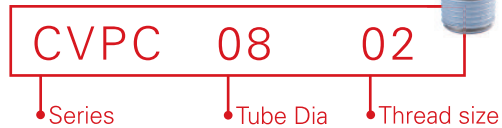

## CHECK VALVES

>METRIC SYSTEM

### CVPC

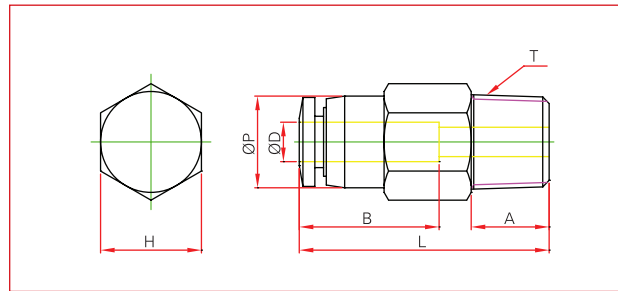

MODEL	ØD	ØP	T	L	A	B	H
CPVC 04M5	4	10	M5XP0.8	31.4	3.6	15.3	10
CPVC C04M6	4	10	M6XP1.0	30.4	4.6	15.3	10
CPVC 0401	4	10	R1/8	27.3	8.0	15.3	10
CPVC 0601	6	11.9	R1/8	32.6	8.0	16.3	12
CPVC 0602	6	11.9	R1/4	32.6	10.0	16.3	14
CPVC 0801	8	14	R1/8	34.9	8.0	18.3	14
CPVC 0802	8	14	1/4	37.2	10.0	18.3	14
CPVC 1003	10	23	R3/8	56.3	11.0	20.3	22
CPVC 1004	10	23	R1/2	58.3	14.0	20.3	22
CPVC 1203	12	25	R3/8	62.3	12.0	23.3	24
CPVC 1204	12	25	R1/2	65.3	14.0	23.3	24

### CVPF

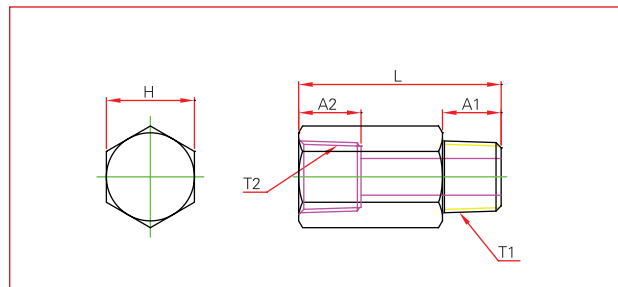

MODEL	T1	T2	L	A1	A2	H
CVPF 01-01	R1/8	R1/8	28.1	8	8	12
CVPF 02-02	R1/4	R1/4	34.1	11	11	17
CVPF 03-03	R3/8	R3/8	53.8	12	12	22
CVPF 04-04	R1/2	R1/2	61.0	14	14	24

**CVPU** union straight

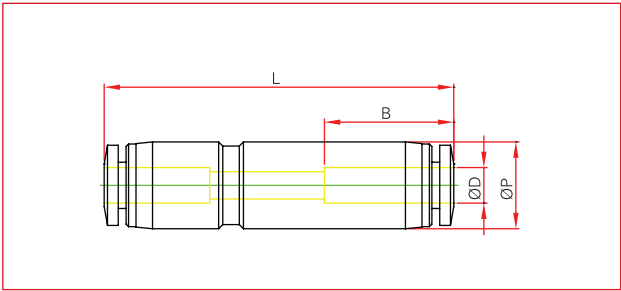

MODEL	ØD	ØP	L	B
CVPU 04	4	10.5	42.3	15.7
CVPU 06	6	12.5	47.5	17
CVPU 08	8	14.8	56.4	19.1
CVPU 10	10	23	65.2	20.5
CVPU 12	12	25	73.0	23.3